

Synthetic straight conduit connector with plug-in connection

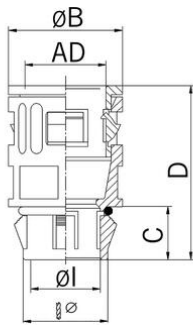

Synthetic straight conduit connector with plug-in connection

- Quick connector RQG1-S
- Black

Article no:	5020.082.221
E-No:	126654005
EAN:	7611614109053
Material	Polyamide impact-resistant
Seal	Conically sealing connection
O-ring	NBR
Fire classification	V0 (UL 94)
Properties	Quick and pull-out-proof installation by means of the «push-in» lock, simple dismounting by displacing the snap-in sleeve
Application	For bore holes for wall thickness from 1 - 2.5 mm
Protection class	IP 66
Operation temperature	-40°C / +120°C
Outer diameter	28.5 mm
Drill Ø	28.0 mm
Diameter Ø I	23.5 mm
Diameter Ø B	37.0 mm
Dimension C	17.9 mm
Dimension D	51.9 mm
Dispatch	25